

Notes
1. The drawings are the property of White Design and shall not be used for any other purpose without the written consent of White Design.
2. The drawings are the property of White Design and shall not be used for any other purpose without the written consent of White Design.
3. The drawings are the property of White Design and shall not be used for any other purpose without the written consent of White Design.
4. The drawings are the property of White Design and shall not be used for any other purpose without the written consent of White Design.
5. The drawings are the property of White Design and shall not be used for any other purpose without the written consent of White Design.
6. The drawings are the property of White Design and shall not be used for any other purpose without the written consent of White Design.
7. The drawings are the property of White Design and shall not be used for any other purpose without the written consent of White Design.
8. The drawings are the property of White Design and shall not be used for any other purpose without the written consent of White Design.
9. The drawings are the property of White Design and shall not be used for any other purpose without the written consent of White Design.
10. The drawings are the property of White Design and shall not be used for any other purpose without the written consent of White Design.
SITE HEALTH AND SAFETY INFORMATION
11. The drawings are the property of White Design and shall not be used for any other purpose without the written consent of White Design.
CONSTRUCTION
12. The drawings are the property of White Design and shall not be used for any other purpose without the written consent of White Design.
MAINTENANCE / CLEANING
13. The drawings are the property of White Design and shall not be used for any other purpose without the written consent of White Design.
RECOMMENDING / REMOVAL
14. The drawings are the property of White Design and shall not be used for any other purpose without the written consent of White Design.

White Design	
OLDROW DEVELOPMENTS LTD.	
RESIDENTIAL DEVELOPMENT FORMER CLOWNE TENNIS CLUB ROOD LANE, CLOWNE	
PROPOSED SITE LOCATION PLAN - EXISTING	
Project No:	004/14/02 500
Scale:	1:1000
Date:	14/02/2014
Author:	White Design
Checker:	White Design
Approver:	White Design
Client:	White Design
Site:	White Design
Project:	White Design
Drawn:	White Design
Checked:	White Design
Approved:	White Design

PLANNING



Notes

1	PROPOSED SITE LAYOUT	1:100	DATE: 08/20/18
2	PROPOSED SITE LAYOUT	1:100	DATE: 08/20/18
3	PROPOSED SITE LAYOUT	1:100	DATE: 08/20/18
4	PROPOSED SITE LAYOUT	1:100	DATE: 08/20/18
5	PROPOSED SITE LAYOUT	1:100	DATE: 08/20/18
6	PROPOSED SITE LAYOUT	1:100	DATE: 08/20/18
7	PROPOSED SITE LAYOUT	1:100	DATE: 08/20/18
8	PROPOSED SITE LAYOUT	1:100	DATE: 08/20/18
9	PROPOSED SITE LAYOUT	1:100	DATE: 08/20/18
10	PROPOSED SITE LAYOUT	1:100	DATE: 08/20/18
11	PROPOSED SITE LAYOUT	1:100	DATE: 08/20/18
12	PROPOSED SITE LAYOUT	1:100	DATE: 08/20/18
13	PROPOSED SITE LAYOUT	1:100	DATE: 08/20/18
14	PROPOSED SITE LAYOUT	1:100	DATE: 08/20/18
15	PROPOSED SITE LAYOUT	1:100	DATE: 08/20/18
16	PROPOSED SITE LAYOUT	1:100	DATE: 08/20/18
17	PROPOSED SITE LAYOUT	1:100	DATE: 08/20/18
18	PROPOSED SITE LAYOUT	1:100	DATE: 08/20/18
19	PROPOSED SITE LAYOUT	1:100	DATE: 08/20/18
20	PROPOSED SITE LAYOUT	1:100	DATE: 08/20/18
21	PROPOSED SITE LAYOUT	1:100	DATE: 08/20/18
22	PROPOSED SITE LAYOUT	1:100	DATE: 08/20/18
23	PROPOSED SITE LAYOUT	1:100	DATE: 08/20/18
24	PROPOSED SITE LAYOUT	1:100	DATE: 08/20/18
25	PROPOSED SITE LAYOUT	1:100	DATE: 08/20/18
26	PROPOSED SITE LAYOUT	1:100	DATE: 08/20/18
27	PROPOSED SITE LAYOUT	1:100	DATE: 08/20/18
28	PROPOSED SITE LAYOUT	1:100	DATE: 08/20/18
29	PROPOSED SITE LAYOUT	1:100	DATE: 08/20/18
30	PROPOSED SITE LAYOUT	1:100	DATE: 08/20/18
31	PROPOSED SITE LAYOUT	1:100	DATE: 08/20/18
32	PROPOSED SITE LAYOUT	1:100	DATE: 08/20/18
33	PROPOSED SITE LAYOUT	1:100	DATE: 08/20/18
34	PROPOSED SITE LAYOUT	1:100	DATE: 08/20/18
35	PROPOSED SITE LAYOUT	1:100	DATE: 08/20/18
36	PROPOSED SITE LAYOUT	1:100	DATE: 08/20/18
37	PROPOSED SITE LAYOUT	1:100	DATE: 08/20/18
38	PROPOSED SITE LAYOUT	1:100	DATE: 08/20/18
39	PROPOSED SITE LAYOUT	1:100	DATE: 08/20/18
40	PROPOSED SITE LAYOUT	1:100	DATE: 08/20/18
41	PROPOSED SITE LAYOUT	1:100	DATE: 08/20/18
42	PROPOSED SITE LAYOUT	1:100	DATE: 08/20/18
43	PROPOSED SITE LAYOUT	1:100	DATE: 08/20/18
44	PROPOSED SITE LAYOUT	1:100	DATE: 08/20/18
45	PROPOSED SITE LAYOUT	1:100	DATE: 08/20/18
46	PROPOSED SITE LAYOUT	1:100	DATE: 08/20/18
47	PROPOSED SITE LAYOUT	1:100	DATE: 08/20/18
48	PROPOSED SITE LAYOUT	1:100	DATE: 08/20/18
49	PROPOSED SITE LAYOUT	1:100	DATE: 08/20/18
50	PROPOSED SITE LAYOUT	1:100	DATE: 08/20/18
51	PROPOSED SITE LAYOUT	1:100	DATE: 08/20/18
52	PROPOSED SITE LAYOUT	1:100	DATE: 08/20/18
53	PROPOSED SITE LAYOUT	1:100	DATE: 08/20/18
54	PROPOSED SITE LAYOUT	1:100	DATE: 08/20/18
55	PROPOSED SITE LAYOUT	1:100	DATE: 08/20/18
56	PROPOSED SITE LAYOUT	1:100	DATE: 08/20/18
57	PROPOSED SITE LAYOUT	1:100	DATE: 08/20/18
58	PROPOSED SITE LAYOUT	1:100	DATE: 08/20/18
59	PROPOSED SITE LAYOUT	1:100	DATE: 08/20/18
60	PROPOSED SITE LAYOUT	1:100	DATE: 08/20/18
61	PROPOSED SITE LAYOUT	1:100	DATE: 08/20/18
62	PROPOSED SITE LAYOUT	1:100	DATE: 08/20/18
63	PROPOSED SITE LAYOUT	1:100	DATE: 08/20/18
64	PROPOSED SITE LAYOUT	1:100	DATE: 08/20/18
65	PROPOSED SITE LAYOUT	1:100	DATE: 08/20/18
66	PROPOSED SITE LAYOUT	1:100	DATE: 08/20/18
67	PROPOSED SITE LAYOUT	1:100	DATE: 08/20/18
68	PROPOSED SITE LAYOUT	1:100	DATE: 08/20/18
69	PROPOSED SITE LAYOUT	1:100	DATE: 08/20/18
70	PROPOSED SITE LAYOUT	1:100	DATE: 08/20/18
71	PROPOSED SITE LAYOUT	1:100	DATE: 08/20/18
72	PROPOSED SITE LAYOUT	1:100	DATE: 08/20/18
73	PROPOSED SITE LAYOUT	1:100	DATE: 08/20/18
74	PROPOSED SITE LAYOUT	1:100	DATE: 08/20/18
75	PROPOSED SITE LAYOUT	1:100	DATE: 08/20/18
76	PROPOSED SITE LAYOUT	1:100	DATE: 08/20/18
77	PROPOSED SITE LAYOUT	1:100	DATE: 08/20/18
78	PROPOSED SITE LAYOUT	1:100	DATE: 08/20/18
79	PROPOSED SITE LAYOUT	1:100	DATE: 08/20/18
80	PROPOSED SITE LAYOUT	1:100	DATE: 08/20/18
81	PROPOSED SITE LAYOUT	1:100	DATE: 08/20/18
82	PROPOSED SITE LAYOUT	1:100	DATE: 08/20/18
83	PROPOSED SITE LAYOUT	1:100	DATE: 08/20/18
84	PROPOSED SITE LAYOUT	1:100	DATE: 08/20/18
85	PROPOSED SITE LAYOUT	1:100	DATE: 08/20/18
86	PROPOSED SITE LAYOUT	1:100	DATE: 08/20/18
87	PROPOSED SITE LAYOUT	1:100	DATE: 08/20/18
88	PROPOSED SITE LAYOUT	1:100	DATE: 08/20/18
89	PROPOSED SITE LAYOUT	1:100	DATE: 08/20/18
90	PROPOSED SITE LAYOUT	1:100	DATE: 08/20/18
91	PROPOSED SITE LAYOUT	1:100	DATE: 08/20/18
92	PROPOSED SITE LAYOUT	1:100	DATE: 08/20/18
93	PROPOSED SITE LAYOUT	1:100	DATE: 08/20/18
94	PROPOSED SITE LAYOUT	1:100	DATE: 08/20/18
95	PROPOSED SITE LAYOUT	1:100	DATE: 08/20/18
96	PROPOSED SITE LAYOUT	1:100	DATE: 08/20/18
97	PROPOSED SITE LAYOUT	1:100	DATE: 08/20/18
98	PROPOSED SITE LAYOUT	1:100	DATE: 08/20/18
99	PROPOSED SITE LAYOUT	1:100	DATE: 08/20/18
100	PROPOSED SITE LAYOUT	1:100	DATE: 08/20/18

Building to address Rood lane with gated pedestrian access and footpath.
Retain existing hedge with post and wire fence.
Gated pedestrian access from Rood Lane. Existing gates retained. New gated entrance to be resident access only controlled with a coded lock.
Retain existing low level wall and post and wire fence. New timber fence to house side of the boundary.

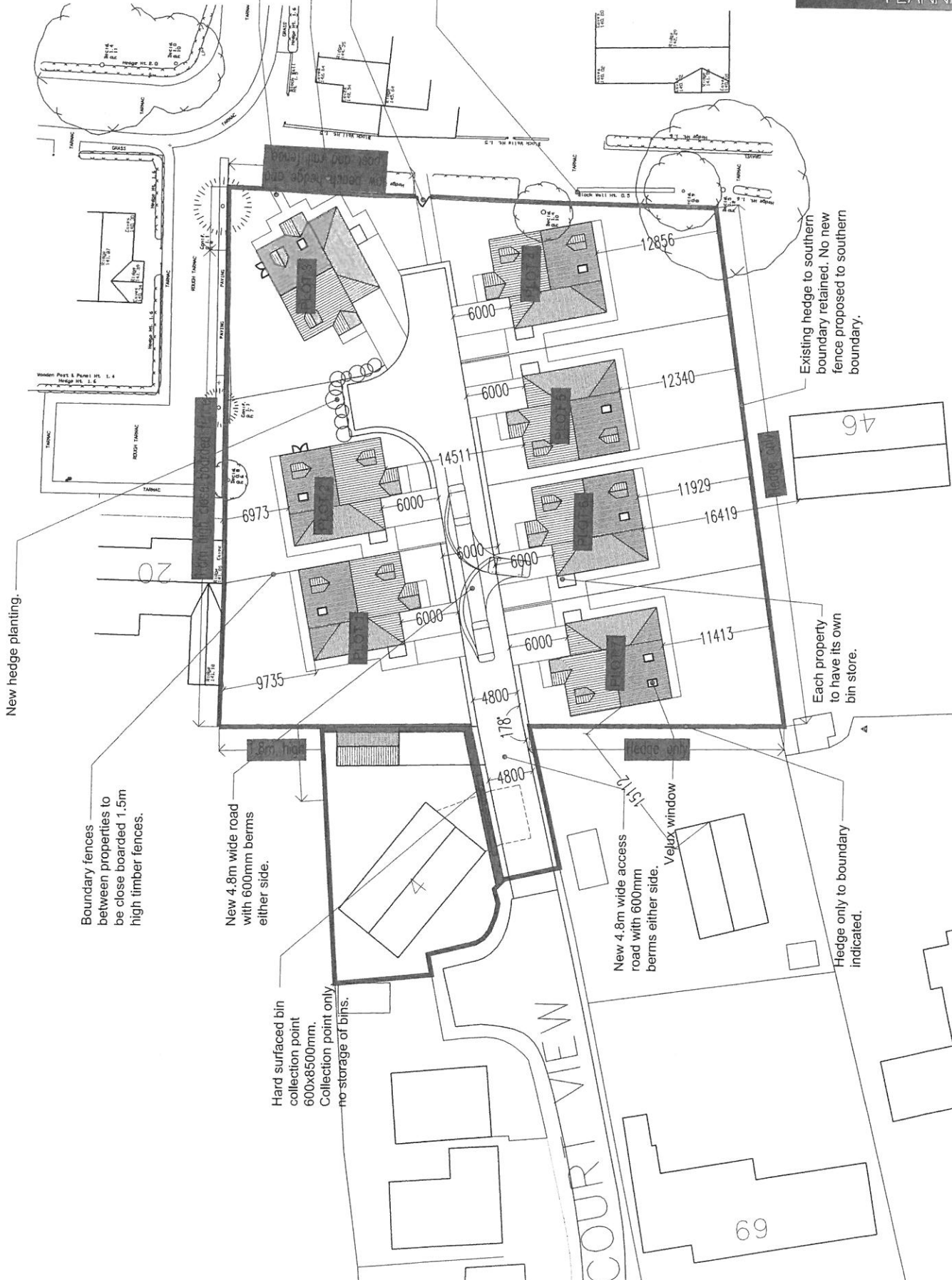

Rev.	Code	Project	Description
1	001	004/14/02 001	Site plan for the proposed development.
2	002	004/14/02 001	Site plan for the proposed development.
3	003	004/14/02 001	Site plan for the proposed development.
4	004	004/14/02 001	Site plan for the proposed development.
5	005	004/14/02 001	Site plan for the proposed development.
6	006	004/14/02 001	Site plan for the proposed development.
7	007	004/14/02 001	Site plan for the proposed development.
8	008	004/14/02 001	Site plan for the proposed development.
9	009	004/14/02 001	Site plan for the proposed development.
10	010	004/14/02 001	Site plan for the proposed development.
11	011	004/14/02 001	Site plan for the proposed development.
12	012	004/14/02 001	Site plan for the proposed development.
13	013	004/14/02 001	Site plan for the proposed development.
14	014	004/14/02 001	Site plan for the proposed development.
15	015	004/14/02 001	Site plan for the proposed development.
16	016	004/14/02 001	Site plan for the proposed development.
17	017	004/14/02 001	Site plan for the proposed development.
18	018	004/14/02 001	Site plan for the proposed development.
19	019	004/14/02 001	Site plan for the proposed development.
20	020	004/14/02 001	Site plan for the proposed development.

White Design

OLDROW DEVELOPMENTS LTD.

RESIDENTIAL DEVELOPMENT
FORMER CLOWNE TENNIS CLUB
ROOD LANE, CLOWNE

PROPOSED SITE LAYOUT

Scale: 1:100

Date: 004/14/02 001

Sheet: K

White Design Ltd.
10, The Square, Clowne, Newark, Nottinghamshire, NG24 1JL
Tel: 01639 860000
Email: info@whitedesign.co.uk

PLANNING